

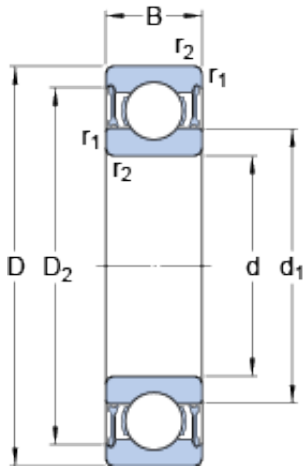

## BEARINGS(UK)LTD.



61906-2RZ Bearing 2D drawings and 3D CAD models

30 mm x 47 mm x 9 mm skf 61906-2RZ Deep groove ball bearings

Bearing No. 61906-2RZ

Size	47x30x9 mm
Bore Diameter	47 mm
Outer Diameter	30 mm
Width	9 mm
d	30 mm
D	47 mm
B	9 mm
d <sub>1</sub>	35.25 mm
D <sub>2</sub>	42.7 mm
r <sub>1,2</sub> - min.	0.3 mm
d <sub>a</sub> - min.	32 mm
d <sub>a</sub> - max.	35.1 mm
D <sub>a</sub> - max.	45 mm
r <sub>a</sub> - max.	0.3 mm
Basic dynamic load rating - C	7.3 kN
Basic static load rating - C <sub>0</sub>	4.6 kN
Fatigue load limit - P <sub>u</sub>	0.212 kN
Reference speed	30000 r/min
Limiting speed	15000 r/min
Calculation factor - k <sub>r</sub>	0.02
Calculation factor - f <sub>0</sub>	14.4
Category	Single Row Ball Bearings
Inventory	17.0
Manufacturer Name	SKF



## BEARINGS(UK)LTD.

Minimum Buy Quantity	N/A
Weight / Kilogram	0.053
Product Group	B00308
Enclosure	2 Seals
Precision Class	ABEC 1   ISO P0
Maximum Capacity / Filling Slot	No
Rolling Element	Ball Bearing
Snap Ring	No
Internal Special Features	No
Cage Material	Steel
Enclosure Type	Non-Contact Seal
Internal Clearance	C0-Medium
Inch - Metric	Metric
Long Description	30MM Bore; 47MM Outside Diameter; 9MM Outer Race Diameter; 2 Seals; Ball Bearing; ABEC 1   ISO P0; No Filling Slot; No Snap Ring; No Internal Special Features
Category	Single Row Ball Bearing
UNSPSC	31171504
Harmonized Tariff Code	8482.10.50.68
Noun	Bearing
Keyword String	Ball
Manufacturer URL	<a href="http://www.skf.com">http://www.skf.com</a>
Manufacturer Item Number	61906-2RZ
Weight / LBS	0.117
Outside Diameter	1.85 Inch   47 Millimeter
Bore	1.181 Inch   30 Millimeter
Outer Race Width	0.354 Inch   9 Millimeter
bore diameter:	30 mm
static load capacity:	4.55 kN



## BEARINGS(UK)LTD.

outside diameter:	47 mm
precision rating:	Not Rated
overall width:	9 mm
finish/coating:	Uncoated
bore type:	Round
cage material:	Steel
closure type:	Double Sealed
outer ring width:	9 mm
row type & fill slot:	Single Row Non-Fill Slot
fillet radius:	0.3 mm
internal clearance:	C0
maximum rpm:	15000 RPM
operating temperature range:	-40 to +210 ° F
series:	61
dynamic load capacity:	7.28 kN
$d_1$	35.25 mm
$D_2$	42.7 mm
$r_{1,2}$ min.	0.3 mm
$d_a$ min.	32 mm
$d_a$ max.	35.1 mm
$D_a$ max.	45 mm
$r_a$ max.	0.3 mm
Basic dynamic load rating C	7.28 kN
Basic static load rating $C_0$	4.55 kN
Fatigue load limit $P_u$	0.212 kN
Calculation factor $k_r$	0.02
Calculation factor $f_0$	14.4
Mass bearing	0.051 kg